

Top View

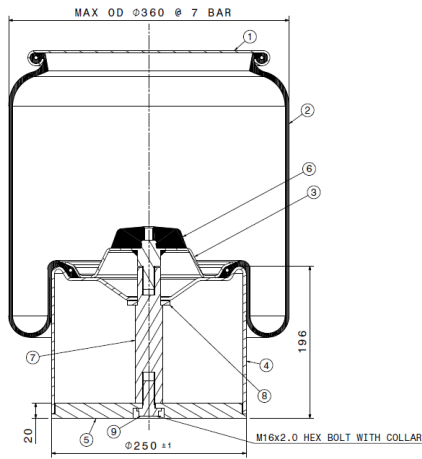

Section View B-B

Section View

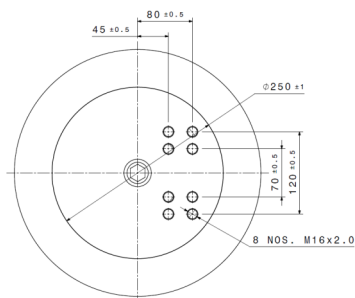

Bottom View

Technical Data

| |
|---|
| Part Description: Crimped reversible sleeve complete assembly |
| Maximum Height: 700mm |
| Maximum Recommended Height: 680mm |
| Design Height: 450mm |
| Minimum Recommended Height: 250 mm |
| Minimum Height: 245 mm |
| Bumper Contact Height: 247 ± 2 mm |
| Working Stroke: 430mm |
| Load Capacity @ 7 BAR @ 450mm (±5%): 50.0kN |
| Maximum OD @ 7 BAR : Ø360mm |
| Required Space: 385mm |
| Weight (±0.5kg) : 23.5kg |

Force (kN)

| Height (mm) | 1 bar | 2 bar | 3 bar | 4 bar | 5 bar | 6 bar | 7 bar | 8 bar |
|-------------|-------|-------|-------|-------|-------|-------|-------|-------|
| 580 | 6.00 | 12.28 | 19.40 | 26.44 | 33.82 | 41.32 | 48.00 | 55.26 |
| 560 | 6.08 | 12.42 | 19.30 | 26.40 | 33.50 | 40.60 | 48.12 | 55.48 |
| 540 | 6.00 | 12.32 | 19.10 | 25.92 | 32.70 | 39.70 | 47.02 | 54.30 |
| 520 | 5.94 | 12.40 | 19.00 | 25.60 | 32.16 | 39.20 | 46.10 | 53.10 |
| 500 | 5.90 | 12.40 | 18.84 | 25.30 | 31.92 | 38.72 | 45.34 | 52.30 |
| 480 | 5.84 | 12.32 | 18.54 | 25.08 | 31.60 | 38.34 | 45.04 | 52.10 |
| 460 | 6.00 | 12.28 | 18.72 | 25.02 | 31.56 | 38.30 | 44.98 | 51.52 |
| 440 | 6.02 | 12.38 | 18.80 | 25.08 | 31.58 | 38.28 | 44.70 | 51.50 |
| 420 | 5.88 | 12.12 | 18.40 | 24.88 | 31.40 | 38.20 | 44.70 | 51.52 |
| 400 | 6.10 | 12.28 | 18.64 | 25.16 | 31.50 | 38.30 | 45.00 | 51.78 |
| 380 | 5.98 | 12.26 | 18.70 | 25.04 | 31.80 | 38.16 | 44.80 | 51.50 |
| 360 | 6.10 | 12.30 | 18.80 | 25.06 | 31.60 | 38.10 | 44.84 | 51.78 |
| 340 | 6.08 | 12.40 | 18.82 | 25.26 | 31.60 | 38.34 | 44.98 | 51.50 |
| 320 | 7.30 | 12.78 | 18.98 | 25.32 | 31.88 | 38.38 | 45.20 | 51.78 |
| 300 | 9.40 | 15.60 | 21.36 | 27.40 | 33.74 | 40.30 | 47.16 | 53.92 |

Graph

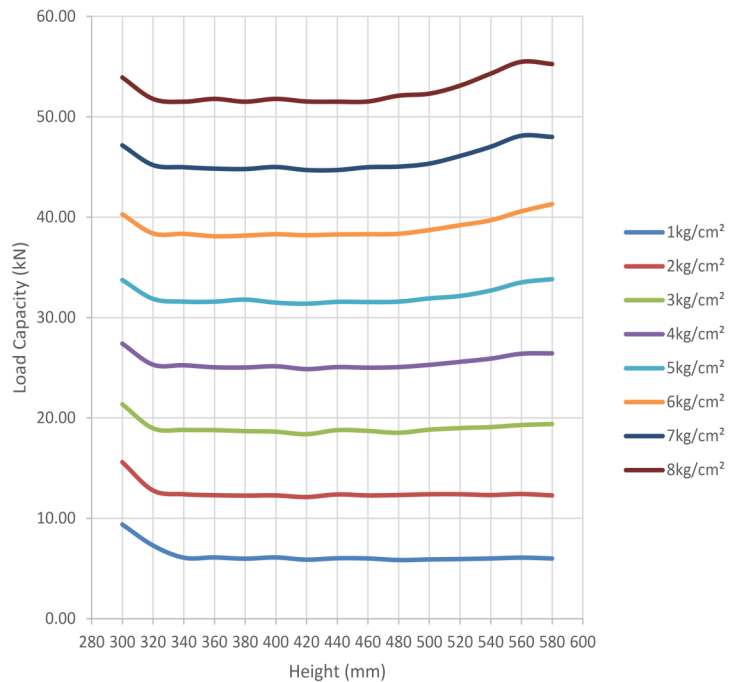

CROSS REFERENCE

| Gibraltar | Firestone | Goodyear | Volvo | Contitech |
|-----------|------------|----------|-------|--------------|
| G66D108 | 1T66D-10.8 | NA | NA | 881 MB N P30 |